

Memo

Legal and Democratic Services

To: For Circulation See Below

Development & Regulatory Law Team
City Hall
Bradford
West Yorkshire
BD1 1HY
DX11758 BRADFORD -1

Ref: 14/00003/1

From: C.E. Barrott
Legal Officer
Development & Regulatory Law Team

Date: 20th May 2014

Tel: (01274) 434751
Fax: (01274) 434242
My Ref: LEG/DEV/CEB/72410
Email: carole.barrott@bradford.gov.uk

TOWN AND COUNTRY PLANNING ACT 1990 - SECTION 198 LAND AT TARN VILLAS, COWPASTURE ROAD, ILKLEY - TREE PRESERVATION ORDER

The above Tree Preservation Order was confirmed on 20th May 2014. Please find attached a copy for your records.

C.E. Barrott

C E Barrott

Enc

Arboricultural Technician
Development Services Tree Section
Department of Regeneration
3rd Floor, Jacobs Well

Land Charges Manager
Local Land Charges
6th Floor Jacobs Well

For TPO's in Ilkley Area (including Menston)
Veronica Clair (Area Clerk)
Department of Regeneration
Ilkley Town Hall

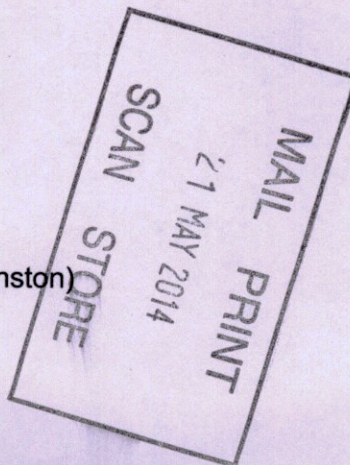

(Document)
G:\DEVELOPMENT\STDS\TP17.DOT (Revised June 2011)

TOWN AND COUNTRY PLANNING ACT 1990

THE LAND AT TARN VILLAS, COW PASTURE ROAD, ILKLEY

TREE PRESERVATION ORDER 2014

The City of Bradford Metropolitan District Council in exercise of the powers conferred on them by Section 198 of the Town and Country Planning Act 1990 make the following Order:-

Citation

1. This Order may be cited as the land at Tarn Villas, Cow Pasture Road, Ilkley Tree Preservation Order 2014

Interpretation

2. (1) In this Order "the authority" means City of Bradford Metropolitan District Council.
- (2) In this Order any reference to a numbered section is a reference to the section so numbered in the Town and Country Planning Act 1990 and any reference to a numbered regulation is a reference to the regulation so numbered in the Town and Country Planning Act (Tree Preservation) (England) Regulations 2012.

Effect

3. (1) Subject to article 4, this Order takes effect provisionally on the date on which it is made.
- (2) Without prejudice to subsection (7) of section 198 (power to make tree preservation orders) or subsection (1) of section 200 (tree preservation orders: Forestry Commissioners) and, subject to the exception in regulation 14, no person shall:-
- (a) cut down, top, lop, uproot, wilfully damage, or wilfully destroy; or
- (b) cause or permit the cutting down, topping, lopping, wilful damage or wilful destruction of,

any tree specified in the Schedule to this Order except with the written consent of the authority in accordance with regulations 16 and 17, or of the Secretary of State in accordance with regulation

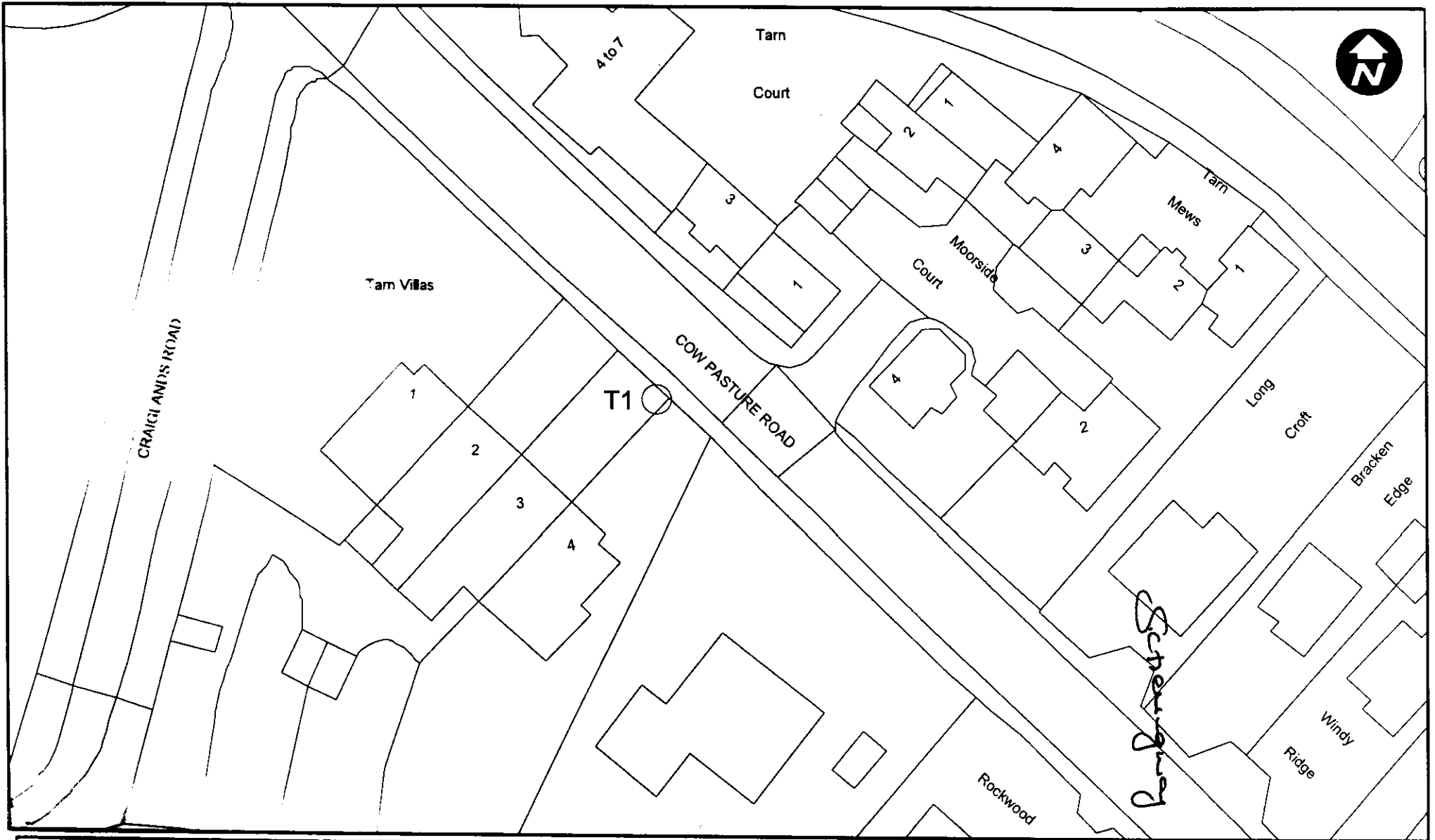

THE PRESIDENT OF THE
 HOUSE OF COMMONS
 DEPARTMENT OF REGENERATION & CULTURE
 HOUSE OF COMMONS
 PARLIAMENTS BUILDINGS
 WESTMINSTER
 LONDON SW1A 0AA

OS Ref : SE 1247
 Reproduced from the Ordnance Survey map with
 the sanction of HM Stationery Office
 Crown Copyright reserved
 LA076120

Scale 1: 500

23 and, where such consent is given subject to conditions, in accordance with those conditions.

Application to trees to be planed pursuant to a condition

- 4. In relation to any tree identified in the first column of the Schedule by the letter "C", being a tree to be planted pursuant to a condition imposed under paragraph (a) of section 197 (planning permission to include appropriate provision for preservation and planting of trees), this Order take effect as from the time when the tree is planted.

Dated this 27th day of February 2014.

EXECUTED AS A DEED by affixing
THE COMMON SEAL of **THE CITY**
OF BRADFORD METROPOLITAN
DISTRICT COUNCIL in the presence of:-

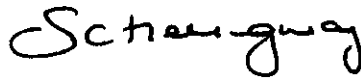

96072.

Authorised by the City Solicitor

CONFIRMATION OF ORDER

This Order was confirmed by the City of Bradford Metropolitan District Council without modification on the 20th day of MAY 2014

OR

The Order was confirmed by the City of Bradford Metropolitan District Council subject to the modification indicated by _____ on the _____ day of _____

EXECUTED AS A DEED by affixing
THE COMMON SEAL of **THE CITY**
OF BRADFORD METROPOLITAN
DISTRICT COUNCIL in the presence of:-



ASSISTANT
Authorised by the City Solicitor

DECISION NOT TO CONFIRM

A decision not to confirm this Order was taken by the City of Bradford Metropolitan District Council on the day of

EXECUTED AS A DEED by affixing
THE COMMON SEAL of **THE CITY**
OF BRADFORD METROPOLITAN
DISTRICT COUNCIL in the presence of:-

Authorised by the City Solicitor

VARIATION OF ORDER

This Order was varied by the City of Bradford Metropolitan District Council on the
day of by a variation order under reference number
a copy of which is attached.

EXECUTED AS A DEED by affixing
THE COMMON SEAL of **THE CITY**
OF BRADFORD METROPOLITAN
DISTRICT COUNCIL in the presence of:-

Authorised by the City Solicitor

REVOCATION OF ORDER

This Order was revoked by the City of Bradford Metropolitan District Council on the day of

EXECUTED AS A DEED by affixing
THE COMMON SEAL of **THE CITY**
OF BRADFORD METROPOLITAN
DISTRICT COUNCIL in the presence of:-

Authorised by the City Solicitor

SCHEDULE**Specification of Trees****Trees specified individually****(enclosed in black on the map)**

Reference on map	Description	Situation
T1	Horse Chestnut	412392 447129

Trees specified by reference to an area**(within a dotted black line on the map)**

Reference on map	Description	Situation
-------------------------	--------------------	------------------

Groups of trees**(within a broken black line on the map)**

Reference on map	Description	Situation
-------------------------	--------------------	------------------

Woodlands**(within a continuous black line on the map)**

Reference on map	Description	Situation
-------------------------	--------------------	------------------